



About Gyokusen'an Rest House

○Overview

Structure Single story wooden structure, shingled roof
 Size 226㎡
 Facilities Restrooms, Information Center,
 12-mat Traditional Room (Tea room),
 8-mat Traditional Room (Tea room),
 Kitchen, Corridor, Lobby, Reception

○Traditional Tea Service

Opening 9:00 until 16:30 (last entry 16:00)
 Hours *No entry between 12:00 and 13:00 due to cleaning
 *Entry may not be possible due to private hire, etc.

Closed on Year-end, New Year (Dec.29 - Jan.3)

○Price of Tea Service

Matcha green tea 730JPY
 (served with fresh *namagashi*, a traditional Japanese sweets)
 *Please contact Gyokusen'an directly for reservations
 for parties of 10 or more

○Private Hire Costs

Morning [9:00-12:00] 13,810JPY Afternoon [13:00-16:30] 16,110JPY
 Day [9:00-16:30] 26,920JPY Evening [17:30-21:00] 20,130JPY
 *Enquiries about private hire should be directed to the Kanazawa
 Castle Park & Kenrokuen Management Center

Bookings and Enquiries

Kanazawa Castle Park & Kenrokuen Management Center
 1-1 Marunouchi, Kanazawa City 920-0937
 Tel 076-234-3800 Fax 076-234-5292
<http://www.pref.ishikawa.jp/siro-niwa/>

Gyokusen'an Rest House Tel/Fax 076-221-5008

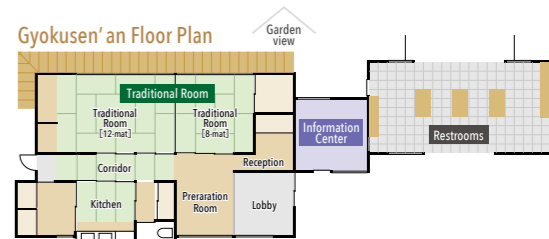

Map of Kanazawa Castle Park



Enjoy blissful moments / overlooking the beautiful garden

Gyokusen'an Rest House is built on the site of a former gardeners' office, which dates back to the Edo period (1603-1868). From inside the Rest House, you can look out over gardens delineated by beautifully designed stone walling, as exemplified by the Shikishi Tanzaku-Zumi Stone Wall.

This is the perfect place to enjoy a few moments of blissful rest, with a cup of Matcha green tea and a traditional Japanese sweets, while drinking in the dynamic beauty of these matchless gardens.

Matcha green tea and freshly
made traditional Japanese sweets.



Gyokusen'an seen from Imori Hill

