



## About Shiguretei

Outline of Facilities	Construction	Wooden single-story construction, shingled roof
	Size	Approx. 270㎡
	Facilities	Zashiki (tea rooms): 8, 8, 10, 10, and 13 mat Yoritsuki (waiting room): 8 mat Mizuya (preparation rooms): 2 Shiguretei Lawn (Open-air tea ceremony ready) Approx.700m <sup>2</sup>

Hours of operation and days closed	Hours of operation	9:00 am – 4:30 pm [Final admission at 4:00 pm]
	Days closed	Year-end and New Year holidays [Dec 29 – Jan 3]

Tea-serving fee	Matcha green tea: 730 yen [served with Shiguretei original Japanese sweets]
	Sencha green tea: 310 yen [served with a Japanese cake]

Category	All day(9:00 - 16:30)	Half day(Morning) (9:00 - 12:00)	Half day(Afternoon) (13:00 - 16:30)
Zashiki 1, 2, 3, 4	48,600 yen	24,930 yen	29,010 yen
Zashiki 5	15,920 yen	8,170 yen	9,530 yen
All facilities	64,530 yen	33,100 yen	38,550 yen

How to apply	To use the facility, please fill in the park & facility usage application form and submit it to the Kanazawa Castle Park & Kenrokuen Management Center between 2 months and 7 days prior to the date of use. * Reservations for tea-serving should be made directly to Shiguretei.
--------------	---------------------------------------------------------------------------------------------------------------------------------------------------------------------------------------------------------------------------------------------------------------------------------------

**Contact**  
 Kanazawa Castle Park & Kenrokuen Management Center, Ishikawa Prefecture  
 1-1 Marunouchi, Kanazawa City 920-0937  
 Tel 076-234-3800 Fax 076-234-5292 <http://www.pref.ishikawa.jp/siro-niwa/>  
**Kenrokuen Shiguretei**  
 1-5 Kenrokumachi, Kanazawa, 920-0936 Tel/Fax 076-232-8841

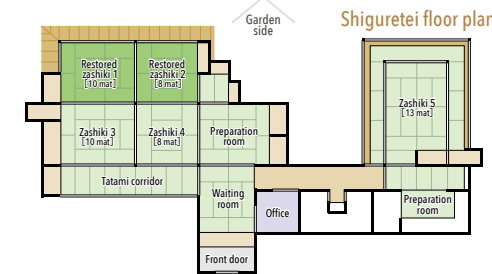



Shiguretei front

In 1676 (Empo 4), Maeda Tsunanori, the 5th lord of the Kaga Domain, moved the construction office inside the castle in order to build a villa on the site called Renchi-ochin and a surrounding garden. This was the beginning of Kenrokuen.

The villa, which was rebuilt by the 6th lord Yoshinori, was located in front of the current fountain up until its destruction at the beginning of the Meiji era. During the latter half of the domain's rule, it was also called Shiguretei. In March 2000, it was restored at its current site. The 10-mat and 8-mat zashiki (tea rooms) facing the garden and the connecting okakoi (small tea room) were restored based on the floor plan preserved from that time.



Restored tea room overlooking roji



Original seasonal Japanese sweets

Roji (tea garden) view from Nure-en porch



Tatami alcove

